

Optional red metal roof shingles.

lovisa



Optional sauna.



Main room showing door into sauna and loft access.

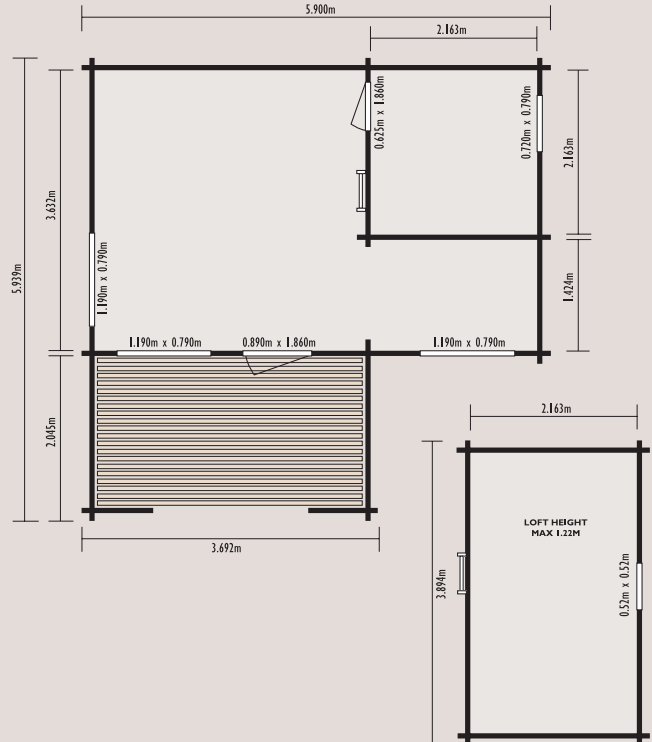

Dimensions	Internal	External (excl. overhangs)
Width	5.638m	5.900m
Depth	3.632m	5.939m
Ridge Height	-	3.320m
Area	20.22m ²	30.52m ²

STANDARD FEATURES

- 45mm Log thickness
- Hexagonal roof shingle tiles
- Toughened glass single glazing
- Decking terrace included

OPTIONAL EXTRAS (SEE PAGES 32-33)

- Extension kit*
- Underfloor heating kit
- Flooring pack
- Guttering kit
- Security
- LED lights
- Toughened glass double glazing
- Red metal roof shingle tiles
- Wood stain & protector
- Sauna conversion kit

*Please note that if used on a side wall, the extension kit would cover a window.